

# Foot Fitting Guide (H)

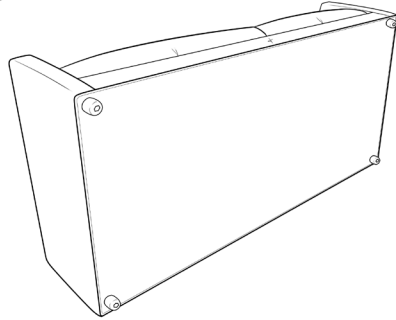

1. With the aid of a second person flip the furniture onto its back.

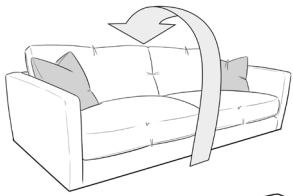
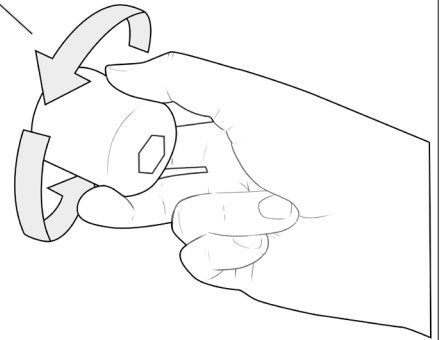
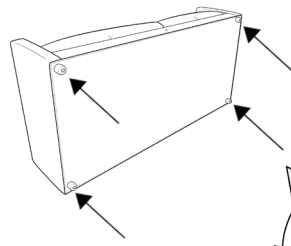

2. Remove the 4 transit glides located under the furniture by turning them anti-clockwise.

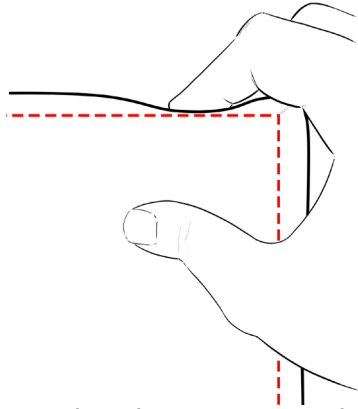
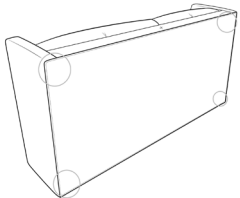

3. Using your fingers feel for the edge of the wooden frame under the upholstery

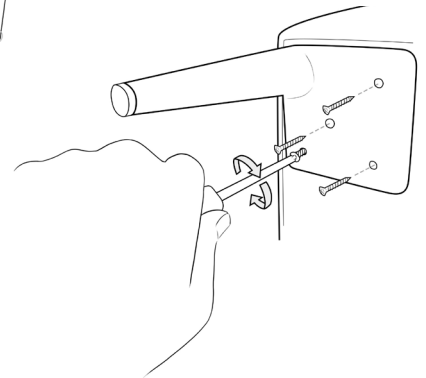
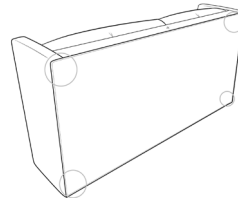

4. After locating the edge of the frame, secure the foot using a pozidrive screwdriver to fasten all 4 screws. Repeat this for remaining feet.

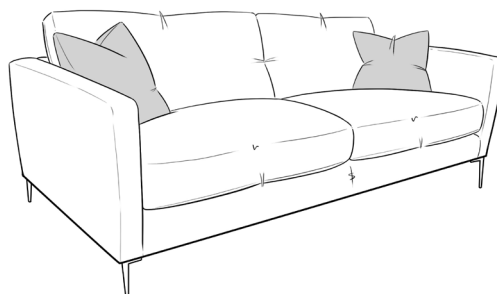
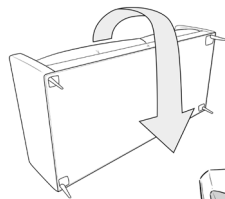

5. With the aid of a second person lift the furniture onto its feet.

PLEASE RESPONSIBLY DISPOSE OF THE REMOVED TRANSIT GLIDES  
DO NOT DRAG THE FURNITURE.  
TWO PERSON LIFT ONLY!